

Resistance thermometer LTS 430

Features

- Standard resistance thermometer without neck tube
- Flat protective fitting without process connection thread
- Protective fitting adaptable with different clamp boltings
- Protective fitting adaptable with different weld-in screwing
- Short reaction time without reduced measuring point
- Temperature resistance PT100 directly constructed in protective fitting
- Electrical connection with M12-plug (connections see accessories)
- Optional with measuring transducer, output 4-20 mA 2-wire
- Specials on request

Technical specifications

- Protective fitting made of stainless steel V4A 1.4404 (316L) resp. V4A 1.4571
- Diameter 6 x 1 mm, other diameters on request
- Temperature range: -50 °C to +150 °C (extended ranges on request)
- Power supply at option measuring transducer 10...35 VDC



LTS 430-9-A-1A-PMU



LTS 430-9-A-1A

Product benefits

- For recording temperatures and optimal space use in liquids and vapors

Pin assignment

1 (brown)
+ voltage
10...35 VDC

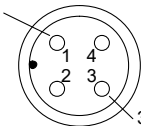

M12 plug with PMU

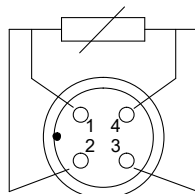

M12 plug
PT100 and PT1000

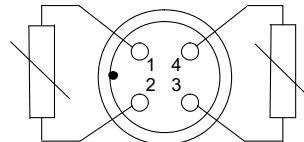

M12 plug
2x PT100 or 2x PT1000

1 (brown)
2 (white)
3 (blue)
4 (black)

Technical drawing

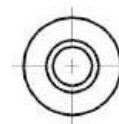
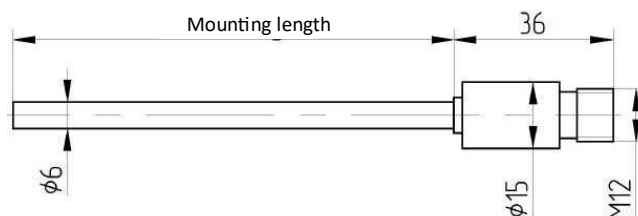

Order-code LTS 430

order example: LTS 430-9-A-1A-PMU (0-100 °C)

Kind of connection

-9 compact construction, directly with M12-plug, protection class IP69K

Mounting length

-A 50 mm mounting length
-B 100 mm mounting length
-C 150 mm mounting length
-D 200 mm mounting length
-E 250 mm mounting length
-F 300 mm mounting length
-K mounting length on customer's wish (please specify length)

Type of sensor and tolerance

-1A 1xPT100 class A
-1A/PT1000 1xPT1000 class A
-KX other types of sensor and tolerance on customer's request

Tapered measuring point

-V0 (without description) without taper
-V3 tapered to 3 mm
-V4 tapered to 4 mm

Optional

-PMU with measuring transducer (please specify required temperature range and configuration)

Accessories

Clamp screw fittings

-99-000197 KVS6E-1/2" clamp screw fitting
-99-000199 KVS6T-1/2" clamp screw fitting with screw-in thread, for 6mm sensor, clamping ring made of Teflon, material 1.4571
-99-000512 KVS6E-1/4" clamp screw fitting
-99-000198 KVS6T-1/4" clamp screw fitting
-99-000196 KKVS6P bullet clamp bolting, for 6mm tube, PEEK sealing ring, material 1.4404

Immersion pockets

-99-000456 THVA, 100mm in G1/2", dimension 9x1, diameter immersion pocket 9mm, inner diameter 7mm, material VA, with M4 screw in the hexagon
-99-001938 THVA-KVS 100mm, in G1/2", sleeve dimension 9x1mm, inner diameter 7mm, with clamp screw fitting for 6mm probe, with PTFE clamping ring
-99-002871 ESTHK, 50mm, welding immersion pocket, diameter pocket 9x1mm, with clamp screw fitting PEEK, material 1.4404

M12-connection wires

-101090 connection cable M12 angled, 4-pole, 5m PVC cable, grey
-101087 connection cable M12 straight, 4-pole, 5m PVC cable, grey

Other lengths available on request.

For more accessories, see accessories data sheet.