

# Safety Pressure Gauges "SOLID-FRONT"

turret case

Type 01.30 - DS 125

# 01.30



These instruments are built in conformity with the construction and safety specifications of **ANSI B40.1**.

In case of leaks or break of the elastic element the operator is protected by a stainless steel safety cell solid front and by the blow-out back. They are usually used in the food, process, pharmaceutical and petrochemical industries and in conventional and nuclear power plants. The TIG welding between the safety cell and the process socket strengthens the instrument and assures a better tight in case of dampening fluid. The advantages of filling the case of the instrument with a dampening fluid are: reduced pointer fluctuation, reduced wear of rotating parts of the movement when pulsant vibrations and pulsations occur. Moreover condensation and corrosive atmospheres which could damage the internal parts.

## Functional and constructive characteristics.

**01.30.2-A** - Glycerine fillable - Lower connection only

**Accuracy:** Grade 2A as per ASME B40.1 ( $\pm 0,5\%$  of span).

**Ambient temperature:** -25...+65°C.

**Process temperature:** -30...+150°C max.

**Working pressure** (referred to the full scale value): max 90% for pulsating pressure; 100% for static pressure.

**Over pressure limit:** 30% of full scale value.

**Protection:** IP 65 as per IEC 529.

**Socket material:** AISI 316L st.st.

**Elastic element:** AISI 316L st.st. by drawn tube without welding.

**Case and blow out disk:** polyammide, fiberglass reinforced, UV stabilized.

**Ring:** polypropylene, fiberglass reinforced.

**Safety cell:** AISI 304 st.st.

**Window:** tempered glass.

**Movement:** stainless steel with internal limit stops for minimum and maximum pressure.

**Dial:** aluminium, white with black markings.

**Pointer:** aluminium, micrometric adjustable.

**Gaskets:** EPDM/NBR.

**Note:** suitable for glycerine filling, silicone oil/Fluorolube filling available on request (code P01).

**01.30.3-A** - Liquid filled - Lower connection only

**Accuracy:** Grade 1A as per ASME B40.1 ( $\pm 1,0\%$  of span).

**Ambient temperature:** max +65 °C, (see DAMPING LIQUIDS table on page 2 for further information)

**Process temperature:** max +65 °C.

**Damping liquids:** glycerine 98%, silicone oil (code S10) or Fluorolube fluid (code F30) on request.

**Compensating device:** EPDM.

**Other features:** as type 1.30.2.A.

TYPE, DIMENSIONS AND WEIGHTS

01.30.2-A  
 01.30.3-A

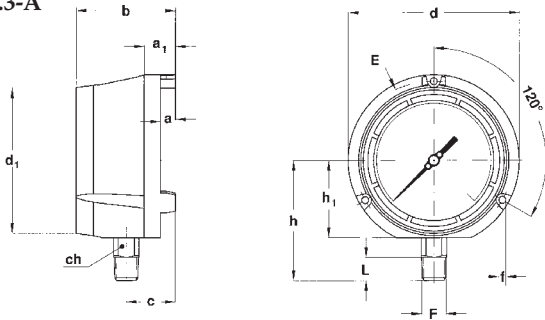

**TYPE A**  
 stem mounting;  
 lower connection.

PROCESS CONNECTIONS

F	Code	L	h
1/4-18 NPT	23M	15	98,5
1/2-14 NPT	43M	20	103,5

(dimensions : mm.)

TYPE	a	a <sub>1</sub>	b	c	d	d <sub>1</sub>	E	f	h <sub>1</sub>	ch	Weight 01.30.2-A	Weight 01.30.3-A
A	13	27	86	42	148	126	137	6,5	66,5	22	0,81 Kg	1,3 Kg

(dimensions : mm.)

01.30.1-D

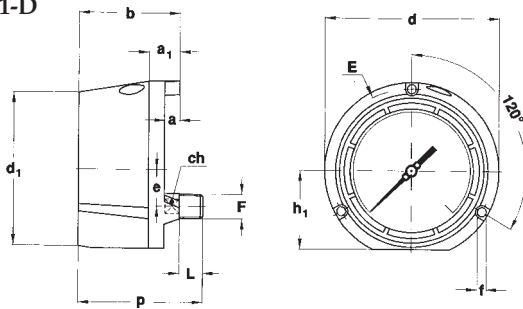

**TYPE D**  
 stem mounting;  
 back connection.

**Dry version - Back connection only**

**Protection:** IP 55 as per IEC 529.

**Case:** phenolic resin.

**Ring and blow out disk:** polypropylene, fiberglass reinforced.

**Safety cell:** not available.

**Other features:** as type 01.30.2-A

TYPE	a	a <sub>1</sub>	b	d	d <sub>1</sub>	e	E	f	h <sub>1</sub>	p	ch	Weight 01.30.1-D
D	13	27	86	148	129	31	137	6	66,5	106	17	1,0 Kg

(dimensions : mm.)

DAMPING LIQUIDS

Damping liquids	Ambient temperature
Gliceryne 98%	+15...+65 °C (+60...+150 °F)
Silicone oil	-45...+65 °C (-50...+150 °F)
"Fluorolube"	-60...+65 °C (-76...+150 °F)

Glycerine or silicone should not be used with highly oxidizing agents such as oxygen, chlorine, nitric acid or hydrogen peroxide, because of danger of spontaneous chemical reaction, inflammability or exposition. The use of fluorinated fluid is recommended in these cases.

## RANGES

### PRESSURE

TAB. 1

RANGE	bar	kPa	MPa	bar ext. psi int.
0÷0,6	◆(1)		◆	◆(1)
0÷	◆		◆	◆
0÷1,6	◆		◆	◆
0÷2,5	◆		◆	◆
0÷	◆		◆	◆
0÷	◆		◆	◆
0÷10	◆		◆	◆
0÷16	◆		◆	◆
0÷25	◆		◆	◆
0÷40	◆		◆	◆
0÷60	◆	◆(1)	◆	◆
0÷100	◆	◆	◆(3)	◆
0÷160	◆	◆	◆(3)	◆
0÷250	◆	◆		◆
0÷300	◆			◆
0÷400	◆	◆		◆
0÷600	◆	◆		◆
0÷1000	◆(3)	◆		◆(3)
0÷1600	◆(3)	◆		◆(3)
0÷2500		◆		

TAB. 2

RANGE	psi	psi int. kPa ext.	psi ext. bar int.
0÷15	◆	◆	◆
0÷30	◆	◆	◆
0÷60	◆	◆	◆
0÷100	◆	◆	◆
0÷160	◆	◆	◆
0÷200	◆	◆	◆
0÷300	◆	◆	◆
0÷400	◆	◆	◆
0÷600	◆	◆	◆
0÷800	◆	◆	◆
0÷1000	◆	◆	◆
0÷1500	◆	◆	◆
0÷2000	◆	◆	◆
0÷3000	◆	◆	◆
0÷4000	◆	◆	◆
0÷5000	◆	◆	◆
0÷6000	◆	◆	◆
0÷10000	◆	◆	◆
0÷15000(3)	◆	◆	◆
0÷20000(3)	◆	◆	◆
0÷30000(2)(3)	◆		◆

### VACUUM & COMPOUND

TAB. 3

RANGE	bar	kPa
-1÷0	◆	
-1÷0,6	◆	
-1÷1,5	◆	
-1÷3	◆	
-1÷5	◆	
-1÷9	◆	
-1÷15	◆	
-1÷24	◆	
-100÷0		◆
-100÷150		◆
-100÷300		◆
-100÷500		◆
-100÷900		◆
-100÷1500		◆
-100÷2400		◆

TAB. 4

RANGE	psi*	psi int.* kPa ext.
-30/0	◆	◆
-30/15	◆	◆
-30/30	◆	◆
-30/60	◆	◆
-30/100	◆	◆
-30/150	◆	◆

\* unit for vacuum: "inHg"

(1) not available for type 01.30.3 (filled)

(2) working pressure: max 75% of the full scale value; over pressure limit: 10% of the full scale value

(3) because of hysteresis, the downscale accuracy is max 1,2% of F.S.V.

**OPTIONS**

DESCRIPTION	Code	01.30.1-D	01.30.2-A	01.30.3-A
Panel mounting kit	F11	◆	◆	◆
"Fluorolube" filling (1)	F30			◆
Suitable for filling with Silicone oil and "Fluorolube" (1)	P01		◆	
Oxygen service	P02	◆	◆ (2)	◆ (3)
Blow out disk with compensating device	FDP		◆	
Without restrictor	S03	◆	◆	◆
Silicone oil filling (1)	S10			◆
Tropicalisation	T01	◆	◆	◆
Stainless steel label	T25	◆	◆	◆
Safety glass window	T32	◆	◆	◆

- (1) gaskets: FPM
- (2) to be ordered with option P01
- (3) to be ordered with Fluorolube filling only (option F30)

**ORDER-CODE:**

<b>01</b>	1- bourdon tube pressure gauges
<b>30</b>	30 - Safety pressure gauge "solid-front", turret case
<b>2</b>	1 - dry version (1) 2 - glycerin fillable version 3 - filled version
<b>A</b>	A - stem mounting, lower connect. D - stem mounting, back connect. (1)
<b>F</b>	F - DS 125
<b>2</b>	1 - up to 2,5 bar 2 - from 4 to 40 bar 3 - over 40 bar
<b>0/100 psi</b>	see ranges table
<b>43M</b>	23M - 1/4-18 NPT 43M - 1/2-12 NPT
<b>T32</b>	see options table

(1) back connection is available as dry version only.

**ACCESSORIES**

**Diaphragm seals:** a complete range of diaphragm seals are available with a choice of materials of construction. Specifically for corrosive and difficult process fluids plus hygienic applications. For further details refer to relevant data sheets.

**Adjustable over-load protector:** this is useful for installations which may generate high overpressures; the pressure gauge is automatically excluded at the pre-set pressure and cut in again automatically when the operating pressure returns to normal. For further details refer to relevant data sheet.

**Valves:** for construction details and for use limits refer to relevant data sheet.

**Pigtail and siphons:** recommended with temperatures of 65° C (150° F) or over. For further details refer to relevant data sheet.

**Pressure snubbers:** for further details refer to relevant data sheet.



**DRUCK & TEMPERATUR Leitenberger GmbH**  
 Postfach 64 • D-72136 Kirchentellinsfurt • Germany  
 Tel.: +49-7121-90920-0 • Fax: +49-7121-90920-99  
 E-Mail: DT-Export@Leitenberger.de  
 INTERNET-Site: <http://www.Leitenberger.com>